

FORM No. 1.

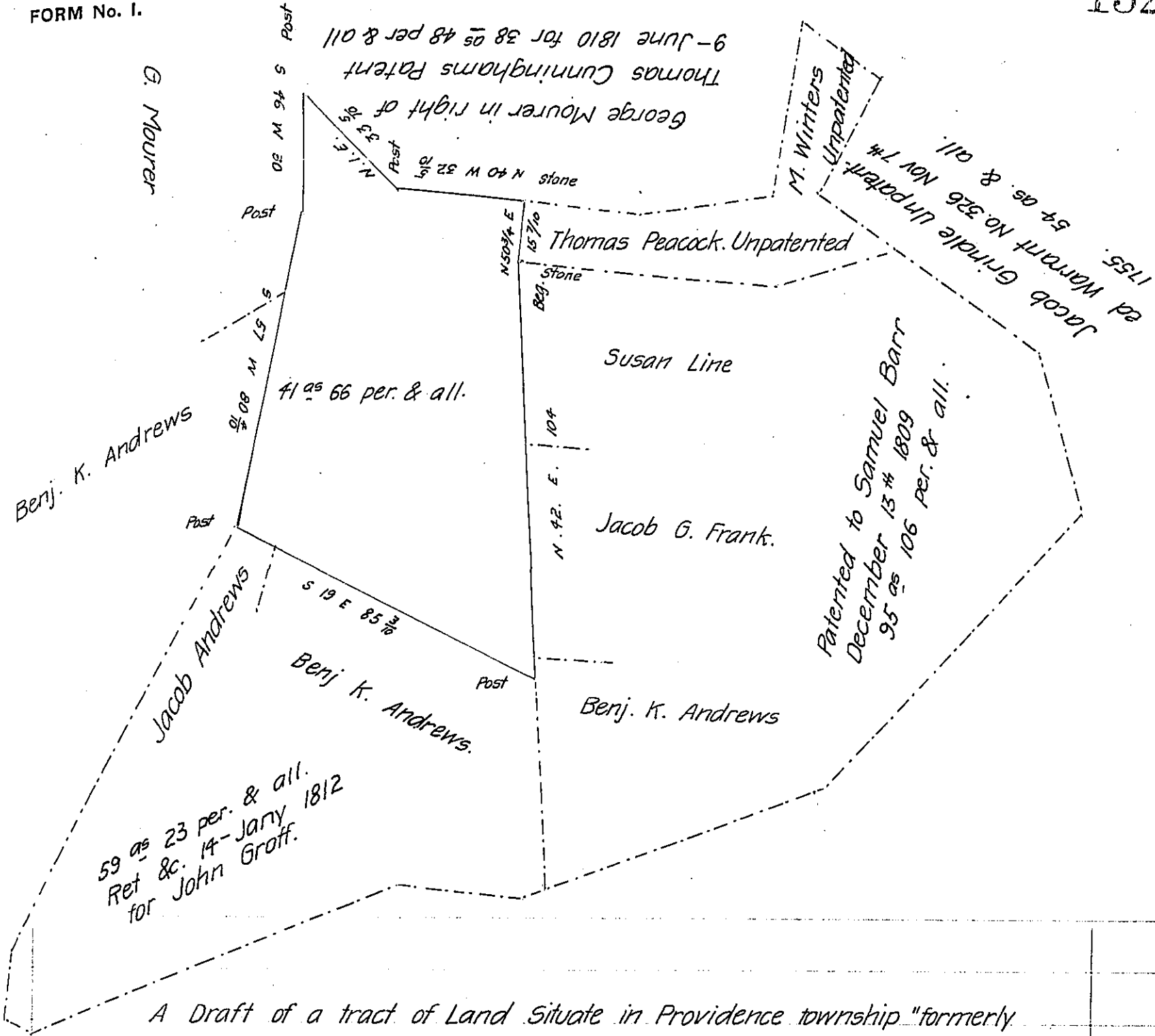

A Draft of a tract of Land Situate in Providence township "formerly Martic" Lancaster County Containing Forty One acres and Sixty six perchs and the allowance of Six Per Cent for roads &c.

Being part of 210 acres & allowance by warrant dated 21st December A.D. 1750 granted to Peter Laurence.

Being the North eastern part, and now surveyed the 18th of February 1873 for Benjamin K. Andrews and Abraham L. Miller.

by

To Jacob Hildebrand
Robert B. Beath Esq County Surveyor
Surveyor General. for Lancaster Co.

IN TESTIMONY that the above is a copy of the original remaining on file in the Department of Internal Affairs of Pennsylvania, made conformably to an Act of Assembly approved the 16th day of February, 1833, I have hereunto set my Hand and caused the Seal of said Department to be affixed at Harrisburg, this fourth day of October 1905.

Loac P. Brown
 Secretary of Internal Affairs.